



**ORVIBO**

# MixSwitch · Bach

User Manual

# Welcome

MixSwitch · Bach series smart switch panel is the 86 type wireless smart switch panel adopting Zigbee wireless communication protocol, which can replace the traditional standard 86 type switch panel to realize the intelligent transformation of lamps.

MixSwitch · Bach supports ORVIBO's proprietary MixCtrl™ technology. You can customize the function of each button and control other devices or scene modes.

# Function

- ① Lights On/Off: The lights can be switched on and off in many ways, such as the switch button, mobile phone APP, MixPad voice, and sensor linkage.
- ② One-key scene control: Customize scenes such as “Go Home” and “Sleep” on the “ORVIBO Home” APP to enable one-key start scenes on the mobile phone APP or MixPad.  
It can also be set to the MixSwitch button, and the scene can be opened by pressing the button.
- ③ Control more devices: You can control curtains, adjust the brightness of the light, adjust the temperature of the air conditioner and play music with ORVIBO curtain motor, smart IR controller, smart light and other devices.

# Packing List

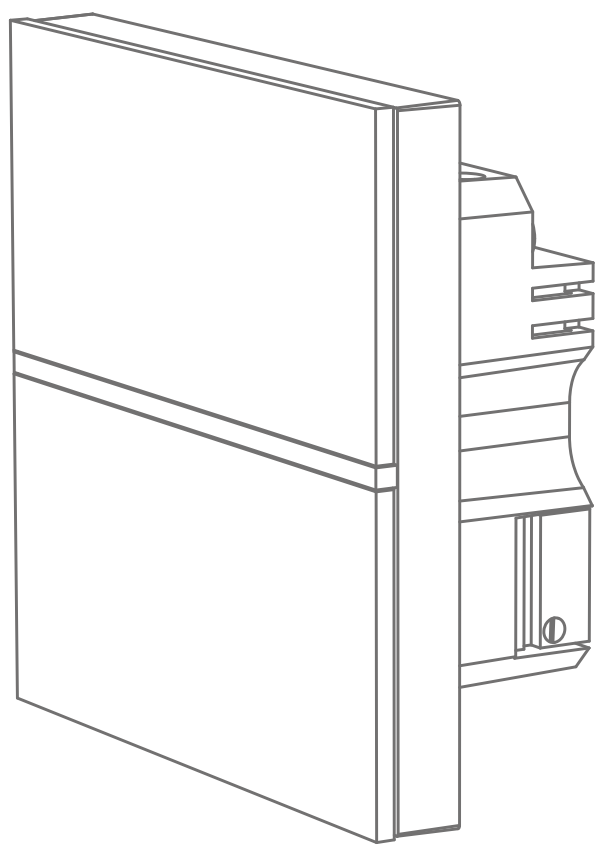

Smart Switch x1

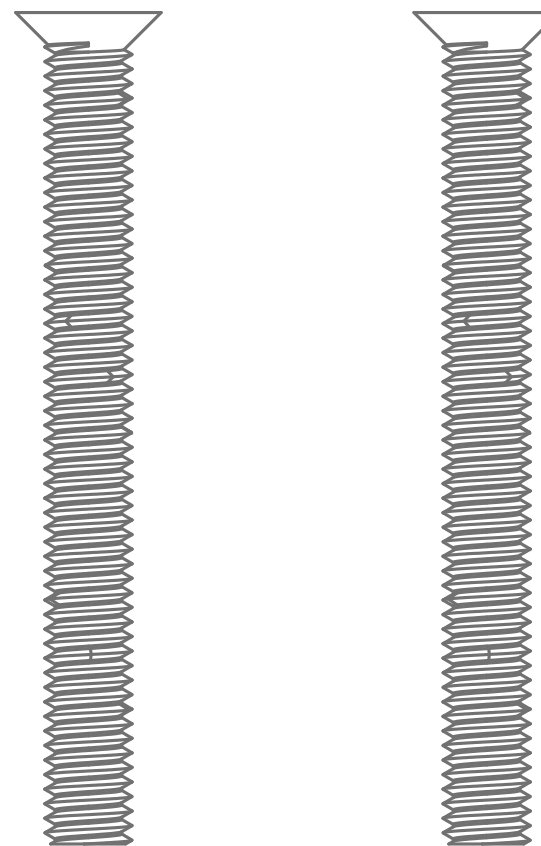

Mounting screw x2

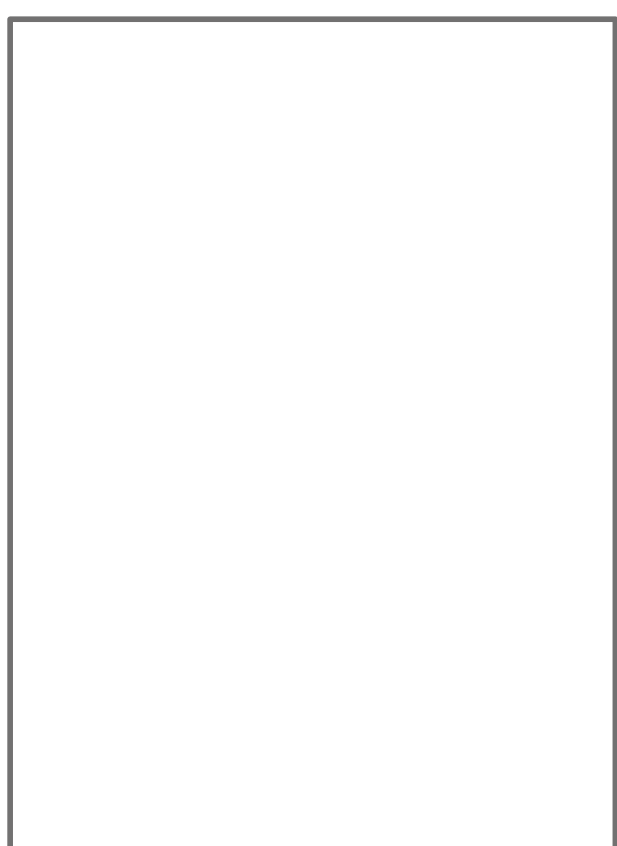

Quick guide x1

# Installation Note

This product is powered by 220V mains.

It must be installed by a professional electrician.

Before installation, please turn off the main gate.

Do not operate with power on.

- ① This product requires neutral live wire power supply. According to the electrical work industry specifications, the neutral wire is generally blue or black wire.
- ② This product needs to be used with MixPad and other products with gateway functions. Please confirm that MixPad is working properly in advance.
- ③ For aesthetic reasons, it is recommended to install with ORVIBO millimeter frame and exclusive cassette.
- ④ Please bring your own M4 screwdriver, test pen, electrical tape and other tools.
- ⑤ This product is for indoor use only. Do not use it in a humid environment such as bathroom.
- ⑥ Cannot be used to control medical equipment, life support equipment, etc.

# Download APP

Search “ORVIBO Home” in the app store, or scan the following QR code to download “ORVIBO Home”

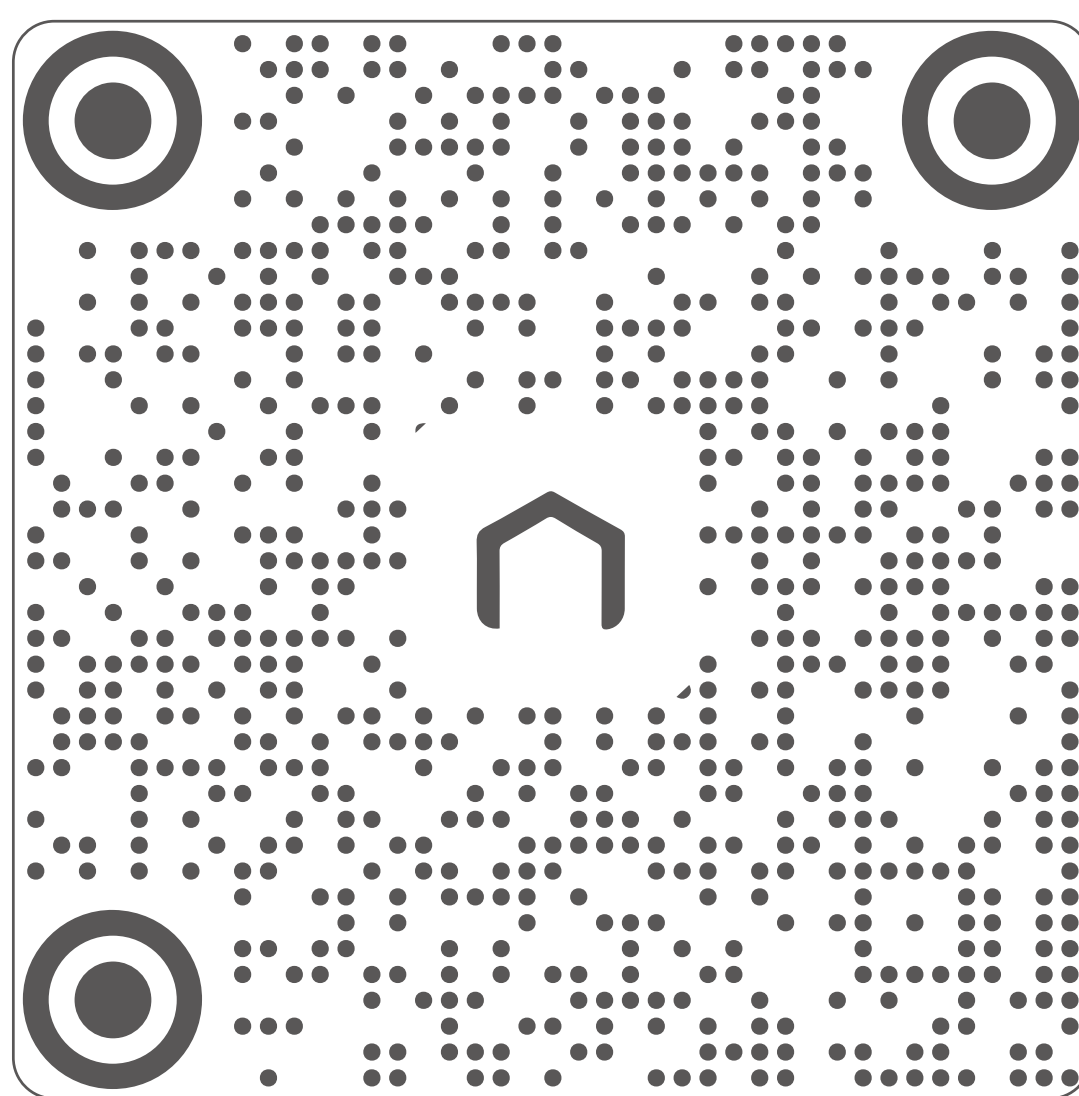

Scan QR code to download  
ORVIBO Home APP

# Installation Steps

- ① Turn off the main power switch, and make sure that there is no cement or other attachments on the inner wall of the cassette. Trim the length of the power cord in the cassette to about 10cm.

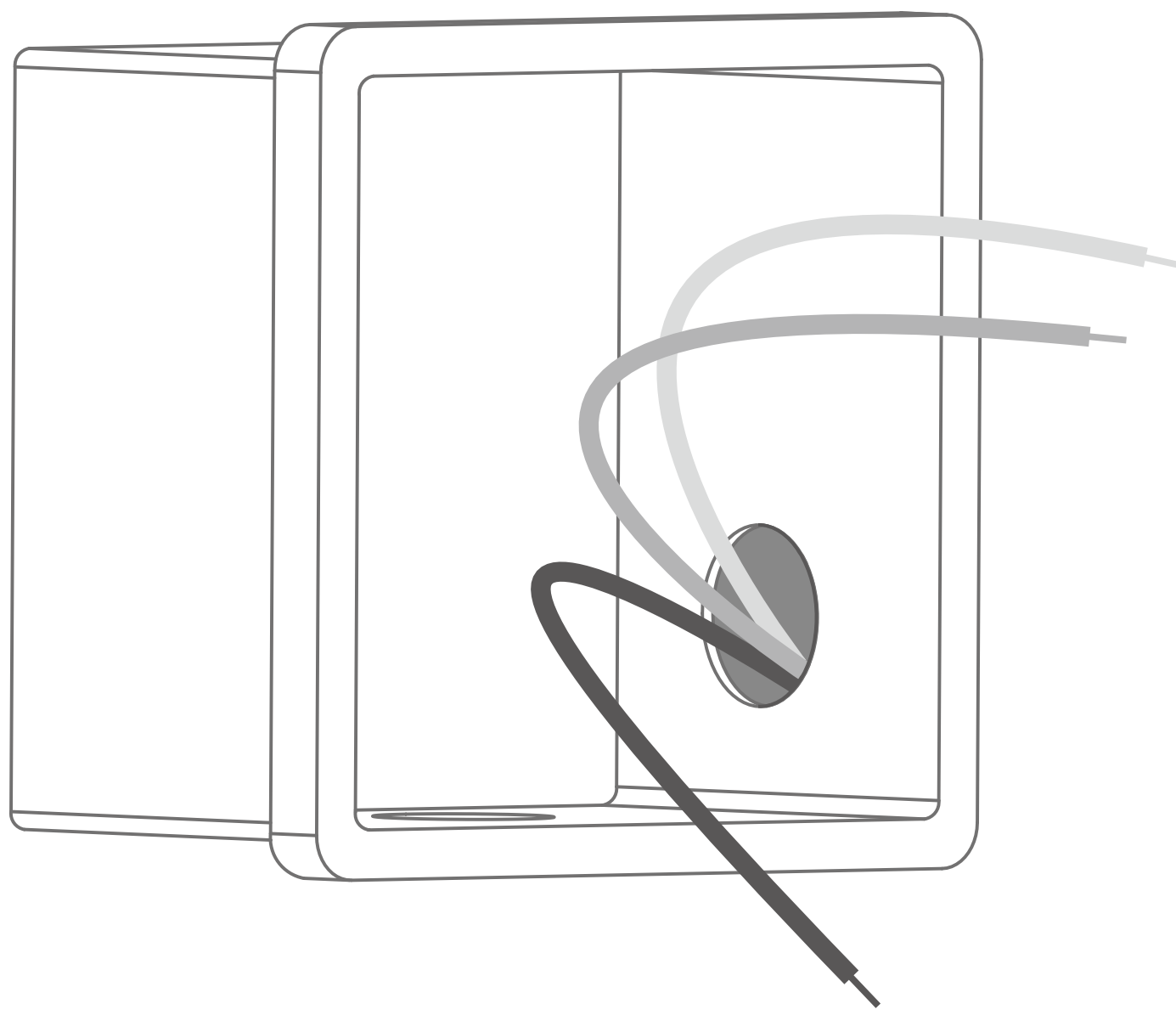

- ② Use a flat-blade screwdriver to pry open the panel.

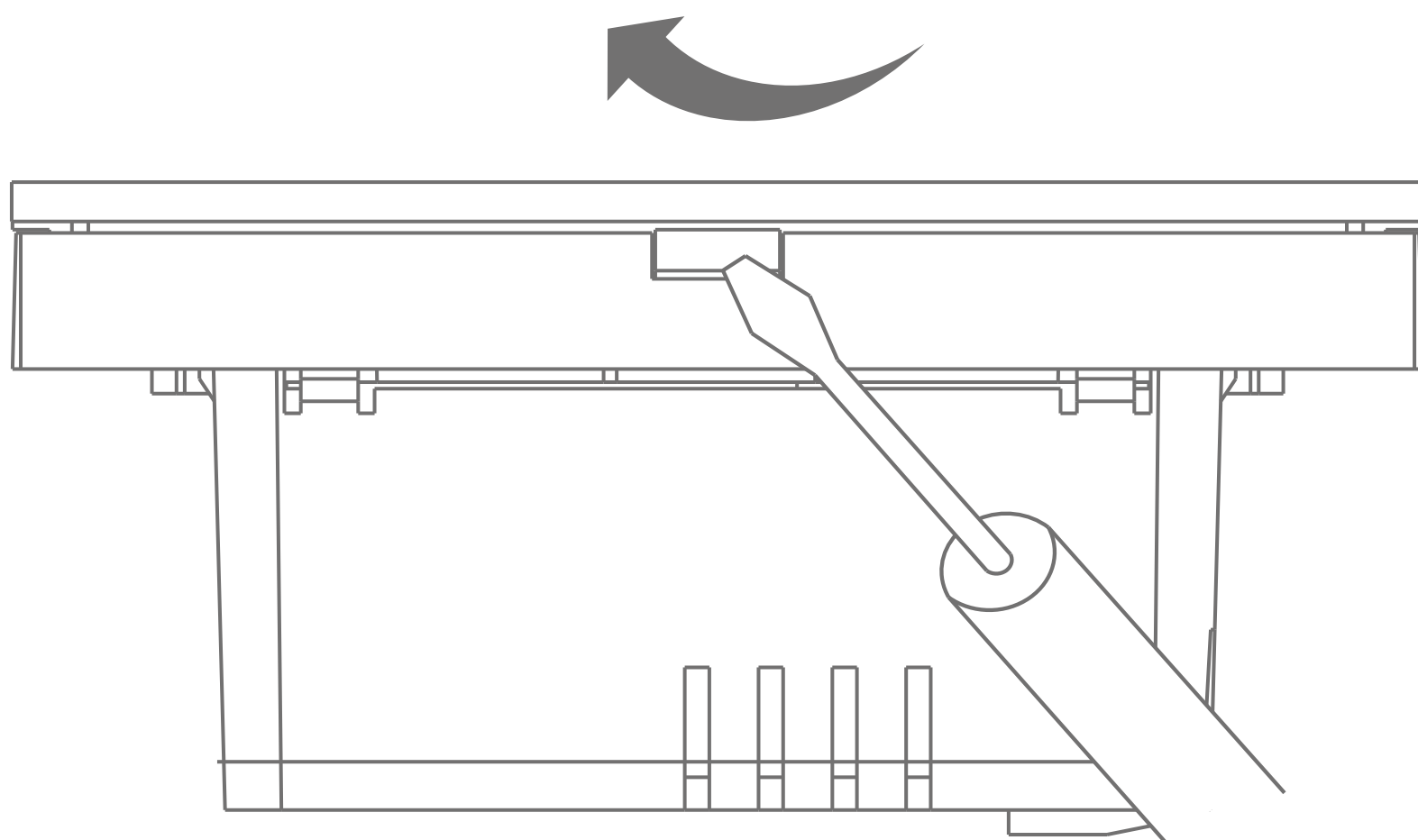

- ③ Connect the live wire to the L interface of the bottom shell of the switch panel, the neutral wire to the N interface of the bottom shell, and the light control wire to the L1/L2/L3/L4 interface of the bottom shell. Make sure that the power cord is in good contact with the switch terminal and there is no bareness of copper wire.

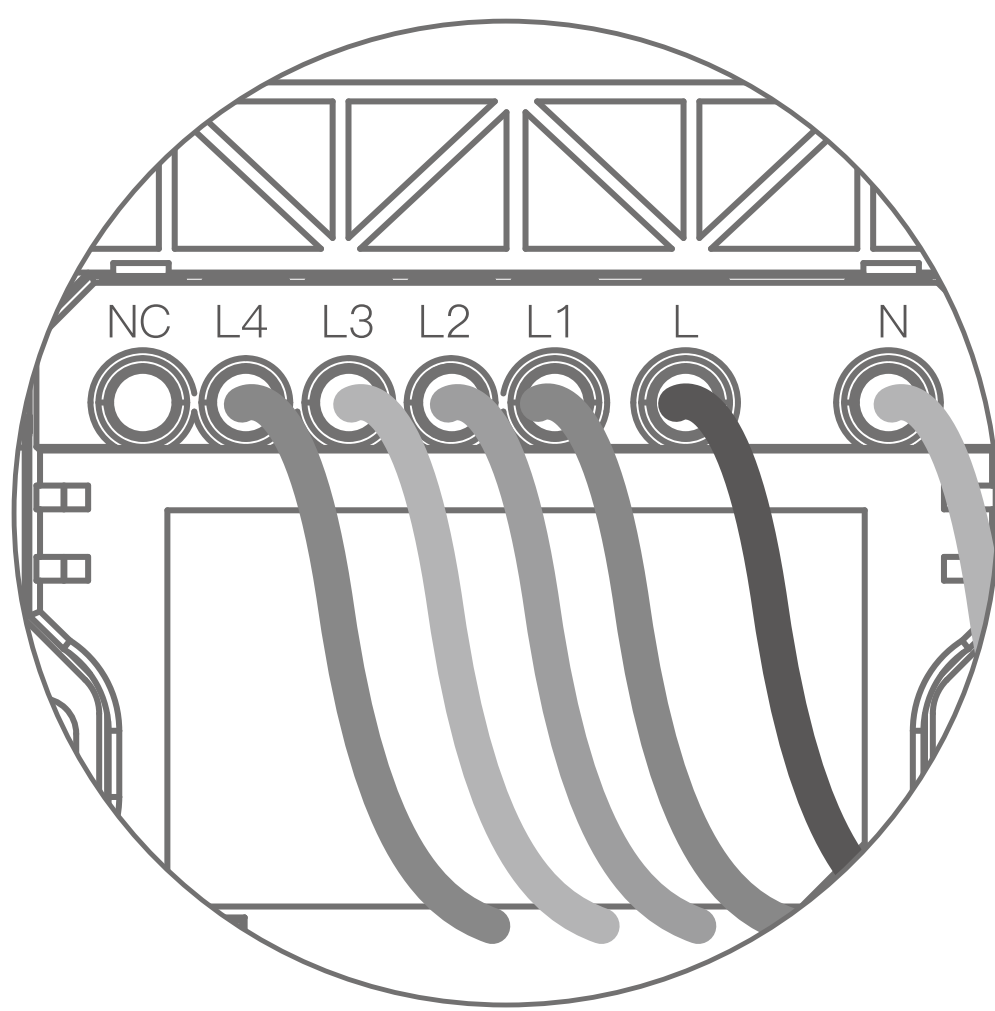

- ④ Use the mounting screws to fix the switch bottom box to the cassette, and buckle the button cover.

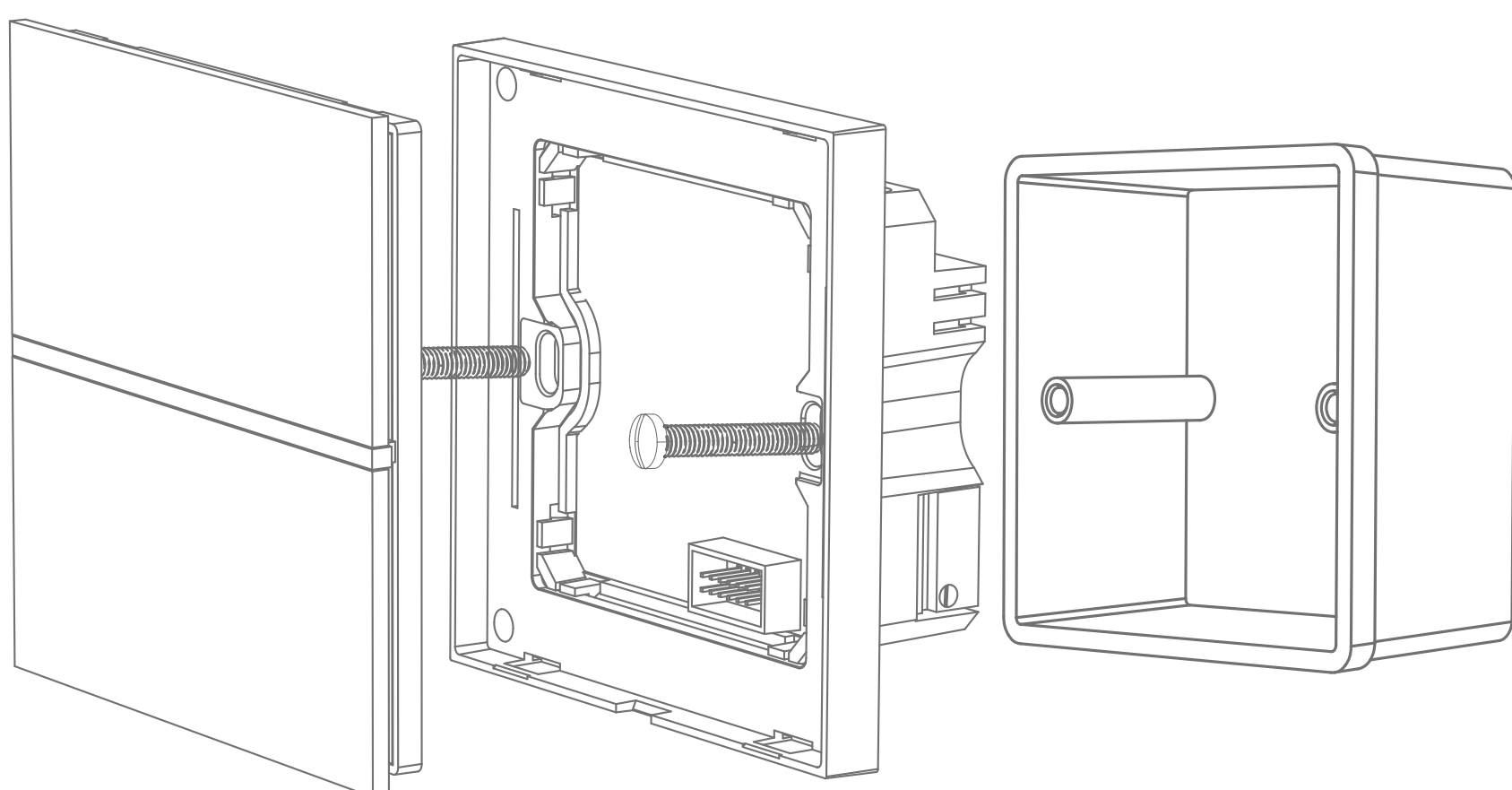



- ⑤ Turn on the main power switch and press the button on the switch panel to control the light normally, indicating that the installation is correct.

# Setting Guide

- ① After the switch is powered on, it will enter the standby state.
- ② Open the “ORVIBO Home” APP, scan the QR code on page 5 again, and search for MixSwitch · Bach. Follow the APP prompts to add the MixSwitch · Bach to MixPad.
- ③ Binding scenes and devices control functions.
  - In the APP, enter the “scene”, set “home” and “sleep” and other scene modes.
  - In the APP, enter “home”, find the corresponding MixSwitch · Bach in the corresponding “room”, and bind the scene mode or device action to each button.
- ④ Use devices
  - When controlling the switch: when the indicator light is weak, it means the switch is off and the light is off; when the indicator light is strong, it means the switch is on and the light is on.
  - When controlling a scene or device: the indicator light keeps strong for 3 seconds and then turns to low light, representing the triggering scene or device.

# Reset

When the smart remote control panel cannot be properly connected to the network or needs to be added to other smart gateways, press any button 4 times in quick succession, long press the 5th time until the panel indicator flashes quickly, and the smart switch will restore the factory settings. Enter the distribution network state again.

# Product Parameters

Model	B10W8 (8 scenes for 4 Gang) B10W4 (4 Gang)
Product size	86×86×38.3mm
Input	100–240V~, 50Hz/60Hz
Maximum load	Max 800W/loop, Max 1200W/total
Wireless protocol	ZigBee 3.0
Working environment	-15°C~50°C, ≤90%RH

# Warranty Range And Duration

One year warranty applies to most ORVIBO product unless other wise specified at the time of purchase. Accessories included with the main device and batteries have a warranty of six months when buying used in ORVIBO products, the product warranty remains measured from the time it was bought by the original owner. Any other promises made by dealers beyond the guarantee of ORVIBO, ORVIBO will not assume any liability.

The following cases do not belong to free repair scope and ORVIBO will provide paid services.

Please note.

Fill to provide warranty card and related sales invoices.

Cleaning of product and wear loss under normal circumstances ( such as natural loss of casing, inserting components, aging andwear ).

Any product failure or damage caused by installation, usage maintenance, and storage that are not in accordance with usage instructions.

Alter or tear up barcode on products or warranty card without authorization.

For those beyond change or warranty period.

Product serial number or type on warranty card does not match the product itself.

Without getting the permission of ORVIBO, change its inherent structure circuit privately, or dismantling or modifying without authorization.

Product damage caused by accident, human abuse/misuse, such as output short circuit, high-voltage input, overload work, high temperature, water inflow, mechanical damage, broken serious oxidation or rusty and etc.

Damage caused by transportation loading and unloading on the way of return for repair.

Product failure or damages caused by force majeure such as earthquake, fire, flood lightning and so on.

Product failure or damaged caused by any problem other than product design, technology, manufacturing, quality and others.

Accessories are not included in free repair scope.

This regulation shall come into effect since the issuing date.

ORVIBO will keep the final interpretation right and revise.

Shenzhen,China 518055,PRC  
7F,Building A7,Nanshan Hi-Tech Incubator,  
No.1001 Xueyuan Avenue ,Nanshan District,  
Shenzhen ORVIBO Technology Co.,Ltd.  
[www.orvibo.com](http://www.orvibo.com)  
[support@orvibo.com](mailto:support@orvibo.com)